



**EMMAUS COLLEGE**  
**ROCKHAMPTON**

22 August 2017

Dear Parents/Guardians

As part of the faith development programme, Year 9 Retreats have been organised for **Tuesday 29<sup>th</sup> and Wednesday 30<sup>th</sup> August**. The retreat theme this year focuses on peer pressure, self-esteem, friendships and belonging.

Each year a lot of thought, preparation and work go into planning and conducting student reflection days, retreats and faith development opportunities.

Emmaus College has been fortunate to procure Project Hatch for the Year 9 Retreat. This Ministry has developed Encounter Days specifically formatted for Years 9-12, which seek to engage students reasoning, judgement, application and evaluative skills while exploring the chosen theme. This is achieved through small group discussions, topical debates, experience based learning activities and prayer experiences. The goal is to encourage students to make connections between their day-to-day life and faith in Jesus Christ.

The Retreats will be split over two days, with one being at the Department of Forests and Fisheries Conference Centre (DAFF) with the Project Hatch Team, and the other at Kemp Beach.

<b>DAY 1 - Tuesday 31<sup>st</sup> August</b>	<b>DAY 2 - Wednesday 1st September</b>
<b>Kemp Beach</b> <b>Tutes</b> 9A – Rob Duivenvoorden 9B – Scott Finlayson 9C – Carl James 9D – Bruce Pope	<b>Kemp Beach</b> <b>Tutes</b> 9E – Frances Murphy 9F – Sarah Pitman 9G – Maree Ogden 9H – Karen Gardner 9I – Genevieve Taylor
<b>DAFF</b> <b>Tutes</b> 9E – Frances Murphy 9F – Sarah Pitman 9G – Maree Ogden 9H – Karen Gardner 9I – Genevieve Taylor	<b>DAFF</b> <b>Tutes</b> 9A – Rob Duivenvoorden 9B – Scott Finlayson 9C – Carl James 9D – Bruce Pope

Students will need to be at DAFF by 8.30am. The Department of Forests and Fisheries Conference Centre is located on the corner of the Bruce Highway and Yeppoon Road. Students are to provide their own transport to and from the venue. Students riding bikes are asked to be especially careful as they will be riding on major roads. A bus will take 'bus students' from Emmaus Main St Campus to the venue, ensuring they return to Emmaus in time to catch their buses in the afternoon. The retreat will finish at 3.00pm. **Please refer to the Map provided for where and how to drop off students at DAFF.**

Students will need to bring water bottles and a packed lunch for the day as there is no canteen at the DAFF.

On the day students are scheduled to go to Kemp Beach, they will need to be at school by 8.30am to travel by bus to the beach. As there are no canteens or shops of any kind, they **must** bring a packed morning tea and lunch. The bus will return students to the school at 3pm.

A roster of Tute Teachers is included detailing which day the students need to attend DAFF and which day they will be travelling to Kemp Beach. Students are to wear full sports uniform or formal uniform to the DAFF. Students attending the beach may wear **suitable** free dress but this must include a **sleeved** shirt, **broad brimmed** or school hat and shorts that reach a minimum length of **mid-thigh**. A water bottle and sunscreen are also required.

Cost for the two days has been added to the Term 3 school fees. This fee covers the services of Project Hatch, supporting the excellent work these young people do in the ministry of their faith and the development of positive outcomes for our school students. It also includes the hire of the DAFF Conference Centre and bus transfers to and from the beach.

This day is a normal school day and is therefore attendance is compulsory, as it is a very significant part of our programme as a Catholic School. Any parents who have any queries are invited to contact their student's Tute Teacher or the Head of Year 9, Mr Andrew Pratt.

Thank you for your support of our retreat program.

Yours sincerely



Mr Andrew Pratt  
**Head of Year 9**

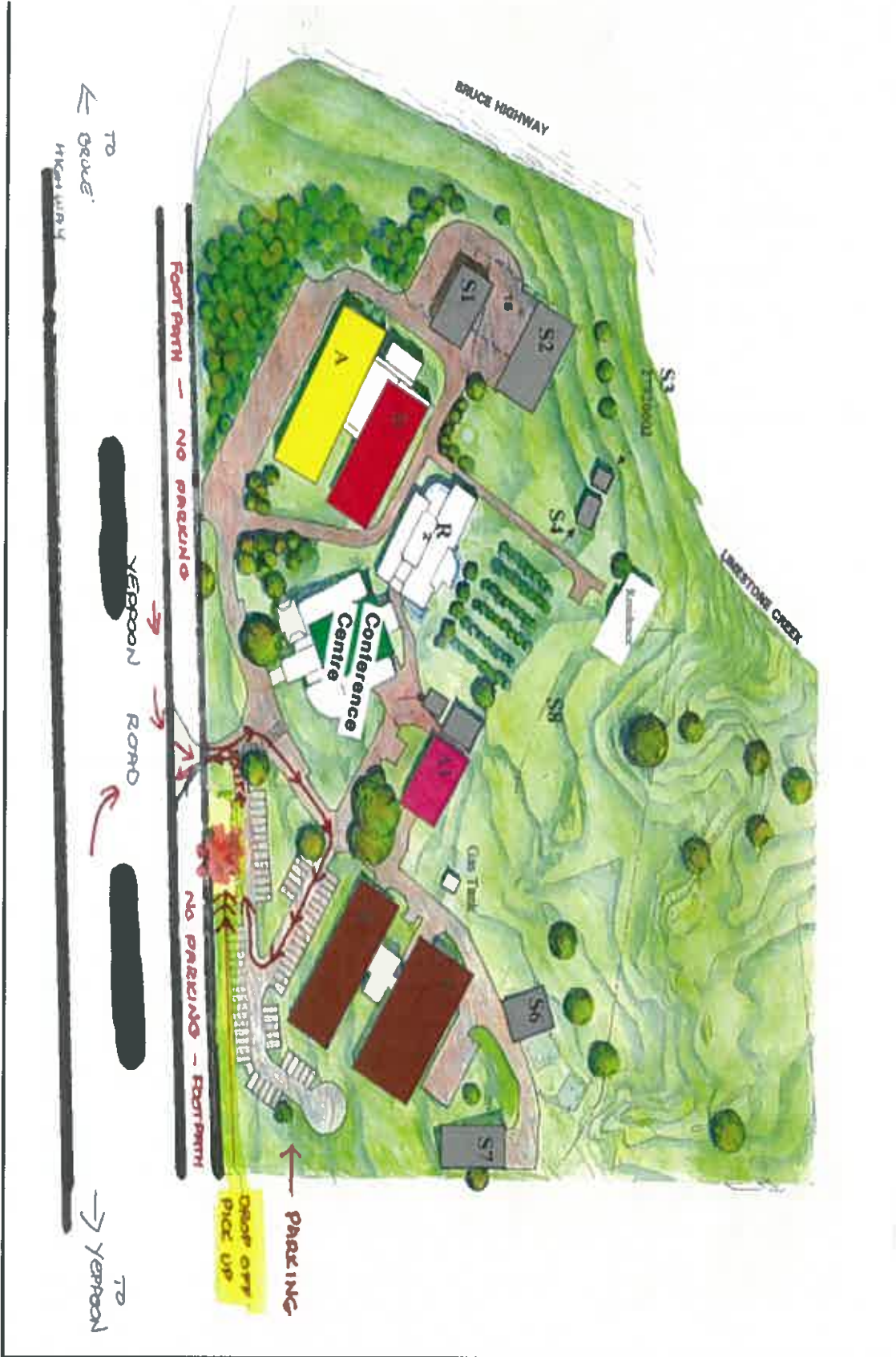

BRUCE HIGHWAY

LIMESTONE CREEK

Footpath - NO PARKING

NO PARKING - FOOTPATH

TO ORANGE

TO YERRON

PARKING

DROP OFF PICK UP

YERRON ROAD

